

HORIZONTAL CURVE

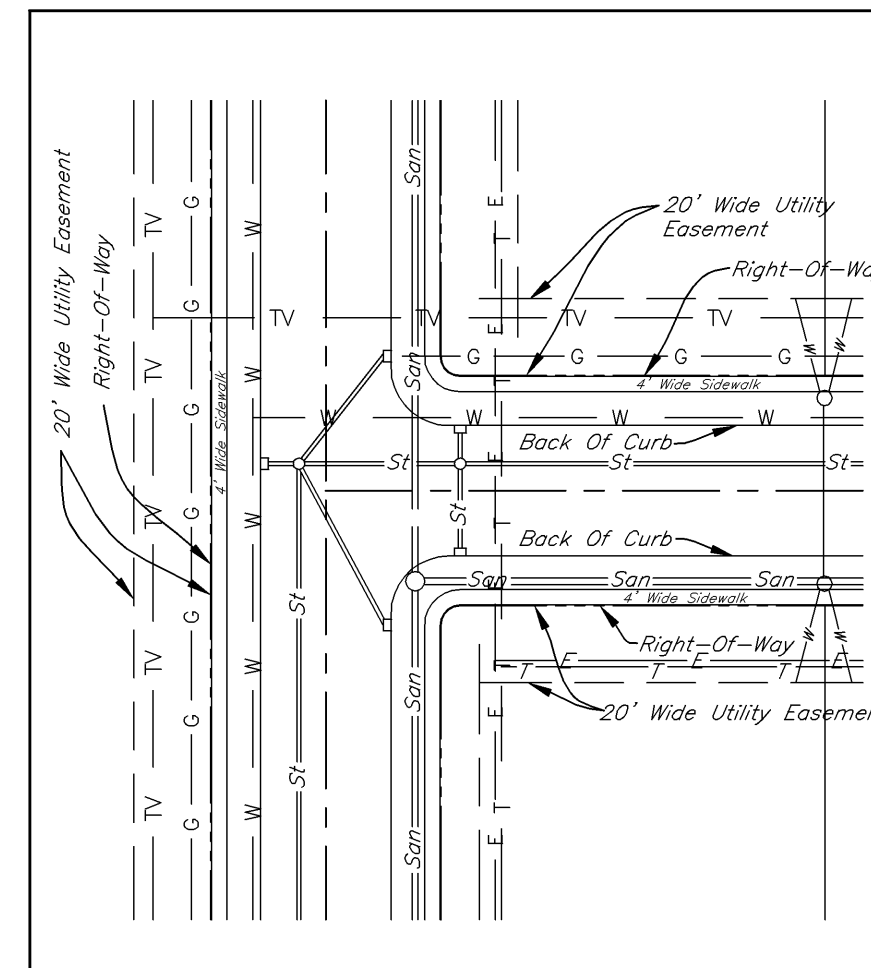

"T"-INTERSECTION
UTILITY ALIGNMENT
Scale: 1"=50'

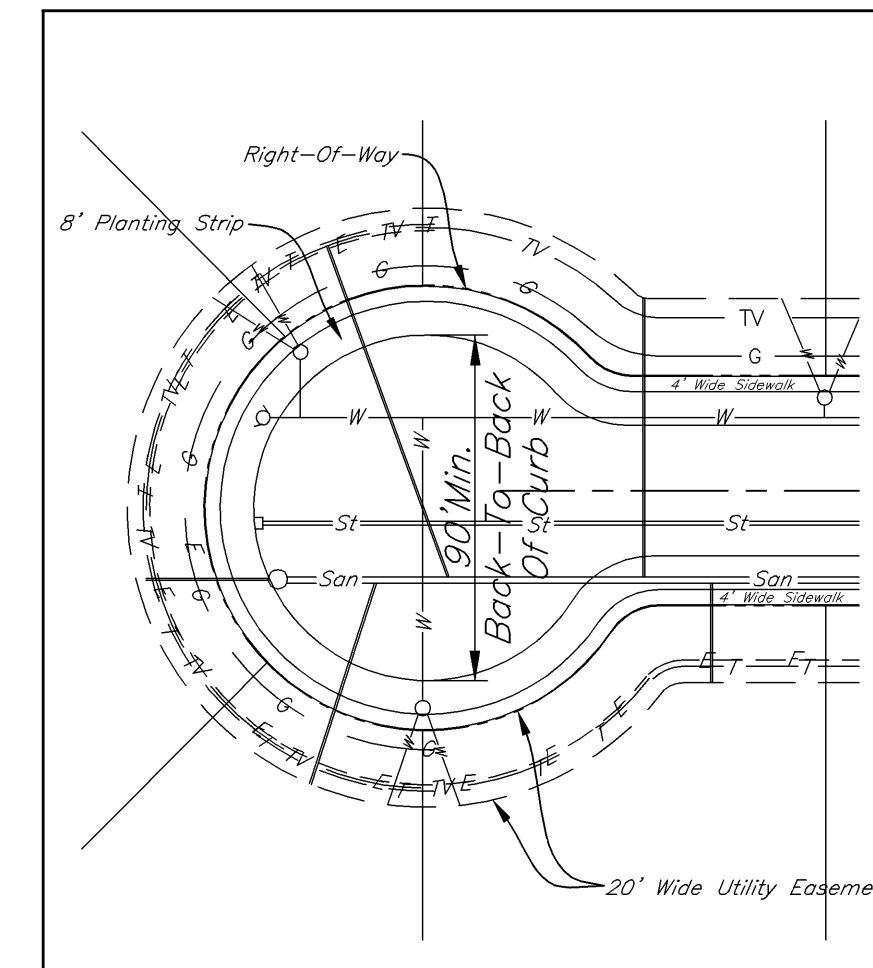

CUL-DE-SAC

GENERAL NOTES:

- 1.) The Location Of Proposed Utilities As Indicated Hereon Are Based Upon The Experience Of The City Of Lebanon And Are So Indicated To Insure The Orderly Development Of The Land. Strict Adherence To The Indicated Location Is Required. Requests To Change The Location Of The Proposed Utilities Shall Be Submitted In Writing To The Utilities Manager. Utilities Not Meeting These Requirements Shall Be Removed And Replaced As Directed By The Utilities Manager.
- 2.) The 8 Foot Wide Planting Strip Must Be Continued Around The Cul-De-Sac, Which Is To Say That The Front Edge Of The Sidewalk Needs To Remain 8 Feet Behind The Back-Of-Curb At All Points Around The Cul-De-Sac.
- 3.) Provide Conduit Crossings As Directed By Lebanon Utilities Electrical Department Which Should Be Made Part Of The Lighting Plans As Required By Sheet 2.

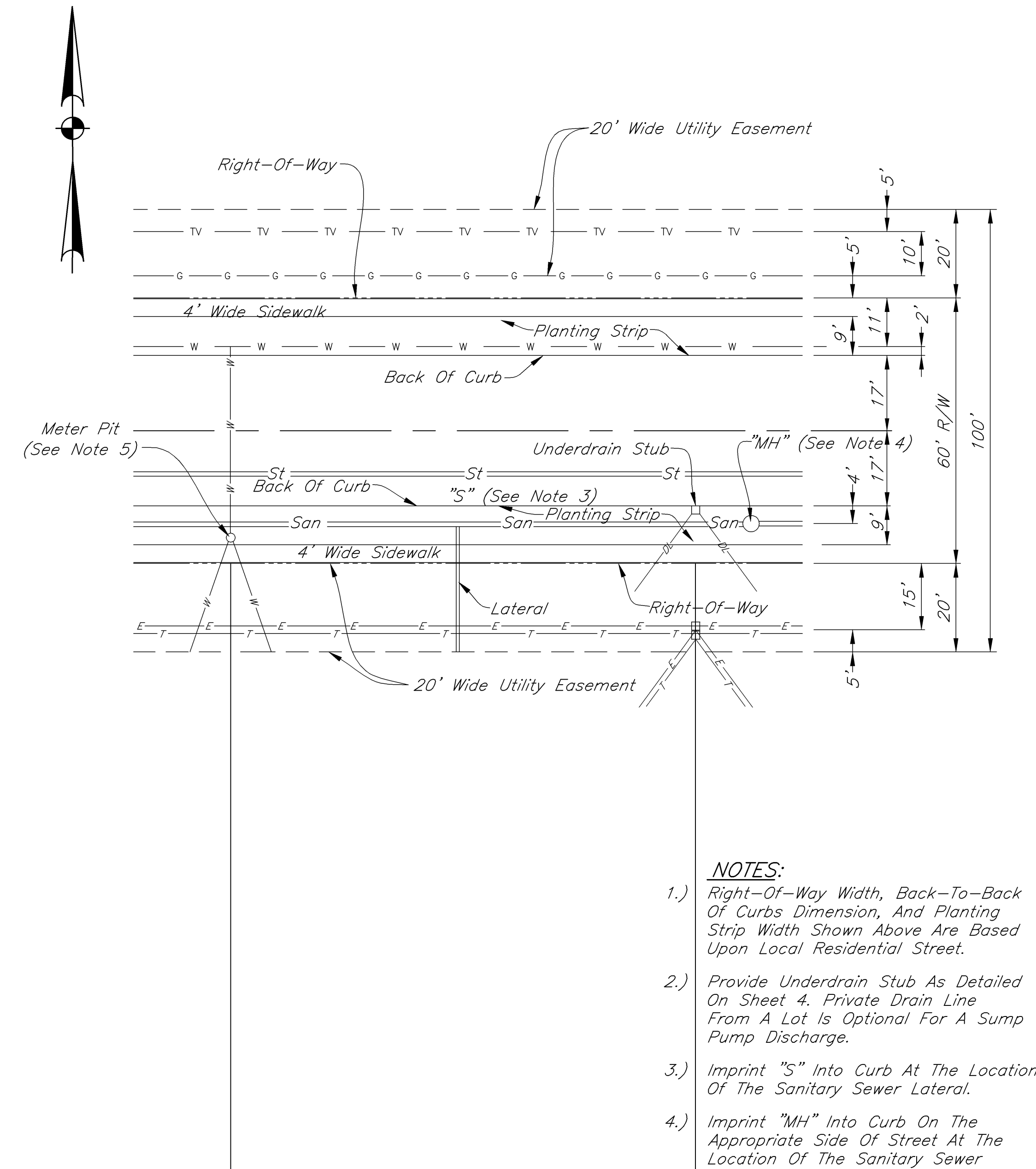

TYPICAL LOT DETAIL
Scale: 1"=20'

NOTES:

- 1.) Right-Of-Way Width, Back-To-Back Of Curbs Dimension, And Planting Strip Width Shown Above Are Based Upon Local Residential Street.
- 2.) Provide Underdrain Stub As Detailed On Sheet 4. Private Drain Line From A Lot Is Optional For A Sump Pump Discharge.
- 3.) Imprint "S" Into Curb At The Location Of The Sanitary Sewer Lateral.
- 4.) Imprint "MH" Into Curb On The Appropriate Side Of Street At The Location Of The Sanitary Sewer Manholes.
- 5.) Centerline Of Meter Pit To Be At Lot Line And 7'-2" Behind Back Of Curb.

LEGEND

- w — w — Water Main
- St — St — Storm Sewer
- San — San — Sanitary Sewer
- G — G — Gas Main
- TV — TV — Cable TV
- E — E — Electric
- T — T — Telephone
- DL — DL — Private Drain Line

C:\3056.89\09\14\UTCAD\ENVR\2004_Standards_Update\Standards.dwg 03-01-06 AT 09:37 1 DDK

REVISIONS		
Rev. No.	Description	Date

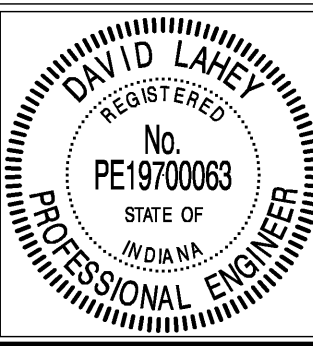

RECOMMENDED FOR APPROVAL	<i>David Lahey</i>	DESIGN ENGINEER	5-4-2006	DATE
APPROVED	<i>Jana M. Bates</i>	MAYOR	6-20-06	DATE
APPROVED	<i>Melvin Matis</i>	UTILITIES MANAGER	6-20-06	DATE

CITY OF LEBANON

PLACEMENT OF UTILITIES

SHEET 3 OF 18